

Aerial view of site

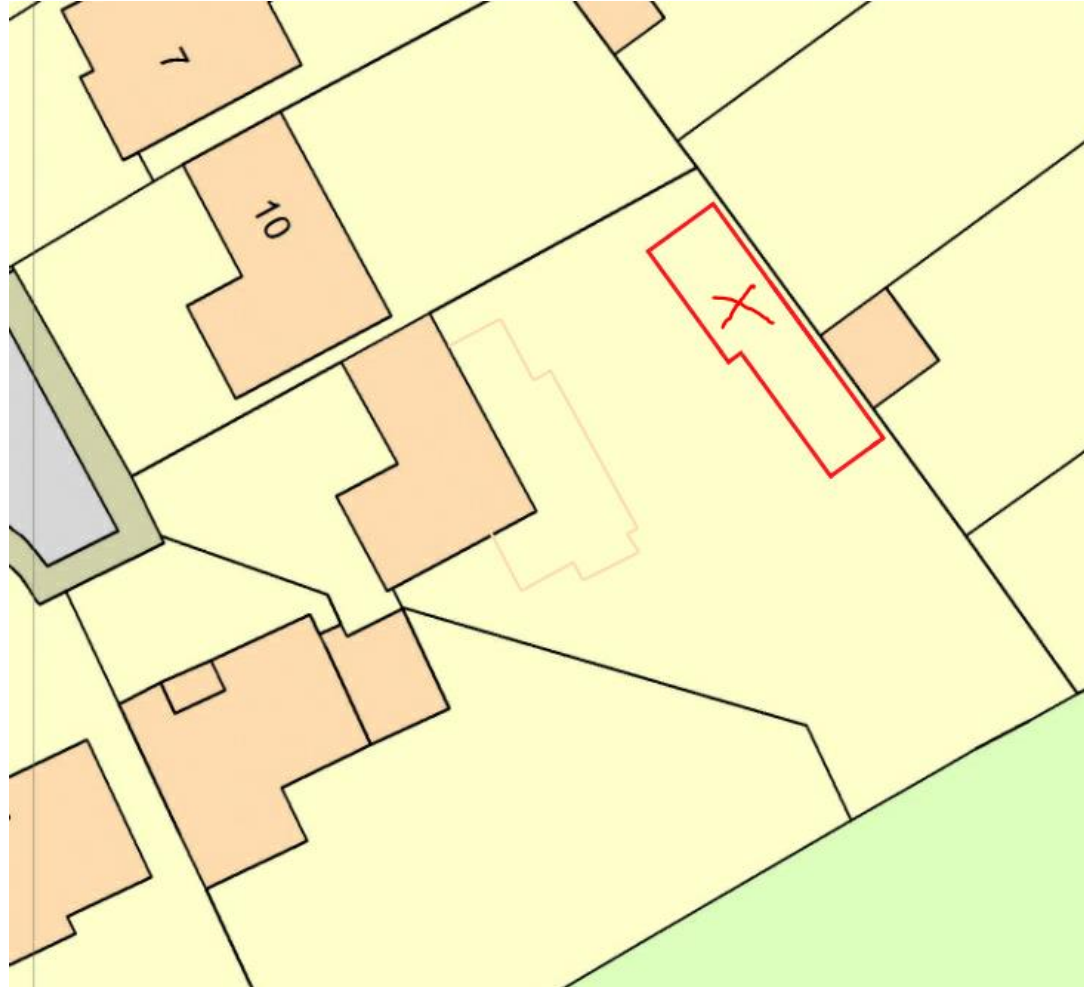

Block plan of the site and annex location

Outline of approved application: 19/00838/FULH Erection of a two storey rear and side extension at side and rear of existing dwelling



Proposed plan

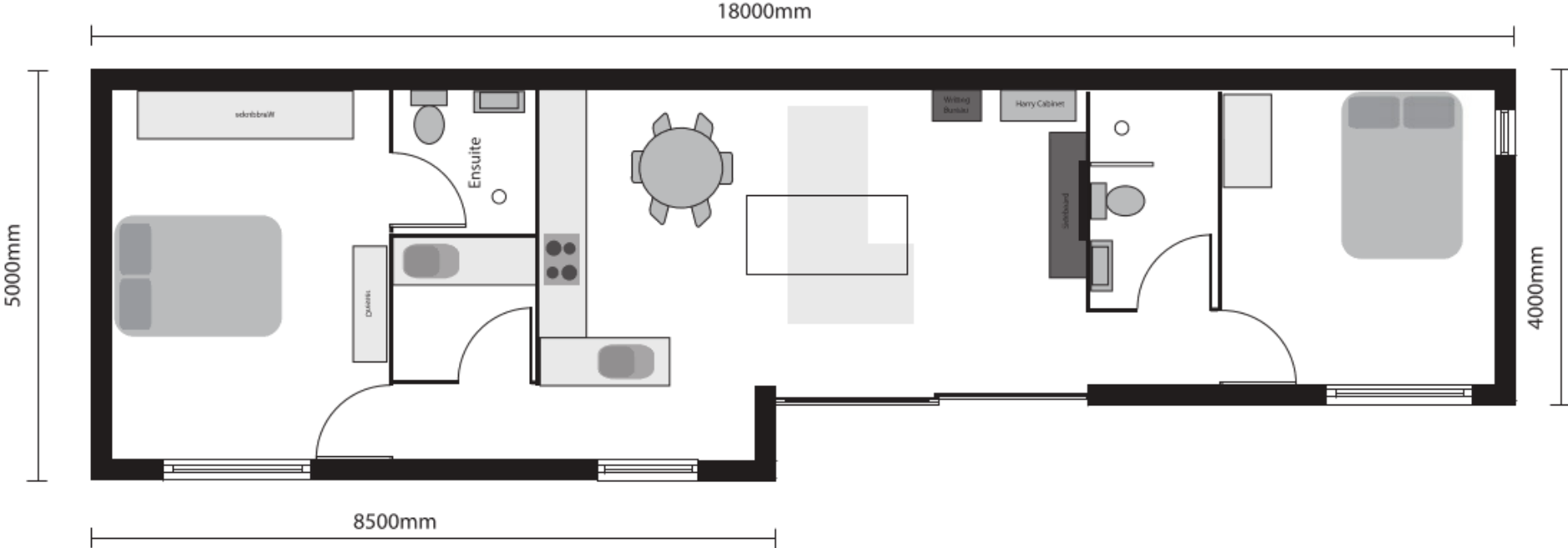

# Proposed elevations



South Elevation



North Elevation



East Elevation



West Elevation



Name: Ryan Smith  
Address: 8 Armand Close Watford, WD17 4SQ  
Drawing No. GA/Elevation 5  
Scale 1:50 @ A3  
01/11/22